

2 TO 4 ZONE WATER TIMER WITH VALVES

INSTRUCTION MANUAL

*2 year warranty to Spring 2009
Bought at 2007 Spring, CT, Fire.*

TOLL FREE HELPLINE: 1-866-523-5218

59-3213-8

Please read completely before installing, programming and operating.

Note: Uses 3 "AA" batteries (not included).

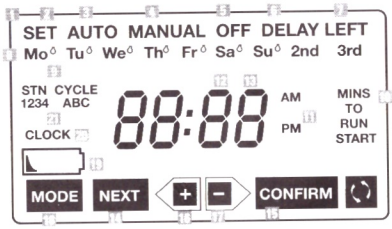

Fig. 1
Key Pad and Display (Fig. 1)

- Ⓐ Indicates different mode settings for programming.
- Ⓑ Select to set day of the week, to set clock time, to set watering days(s), to set watering station and duration, and to set start times.
- Ⓒ Select to use automatic watering mode.
- Ⓓ Select to enable watering manually.
- Ⓔ Select to suspend watering and turn off all stations.
- Ⓕ Select to postpone watering for up to 24 hours.
- Ⓖ Indicates the number of hours remaining on the Delay.
- Ⓗ Indicates current day of the week and the set days for watering.
- Ⓘ Indicates which days are selected for watering.
- Ⓚ Indicates the duration that each station will water.
- Ⓛ Indicates A.M. or P.M. for clock and start time.
- Ⓜ Indicates the time to begin watering.
- Ⓝ Indicates clock, start time and watering duration.
- Ⓟ Push to select or unselect a setting.
- Ⓠ Push to confirm a new setting and advance to the next setting.
- Ⓡ Push to increase numeric setting or advance a setting.
- Ⓢ Push to decrease numeric setting or retract a setting.
- Ⓣ Push to cycle through the different mode settings.
- Ⓤ Indicates low battery, or that batteries need to be replaced.
- Ⓡ Indicates that the setting of the clock and day of the week is in process.
- Ⓢ Indicates which watering cycle is active or being set. Also indicates which watering station is active or being set.
- Ⓣ Pinhole Reset button: Push to reset all programs and settings.

INSTALLATION

GENERAL INFORMATION

1. Location:
 - Choose a spot where water drains away from house and window wells.
 - Warning: For outdoor use. For cold water use only.*
2. Plumbing Codes:
 - Follow all watering and back-flow (anti-siphon) prevention codes.
3. Specifications:
 - Water pressure: 10 psi (min) / 80 psi (max) working pressure

- Working Temperature: 0-75°C (32-167°F)
 - Storage Temperature: -30-85°C (-22-185°F)
 - Uses 3 "AA" batteries (not included).
4. Installing the Batteries (see Fig. 2):
 - Remove timer cover and slide battery compartment cover off in the direction of arrow. Install three 3 "AA" batteries (not included). Slide compartment cover back into place.



- Fig. 2**
- Check the timer periodically for low voltage. When the battery power drops below the safety zone, the 'Low Battery' indicator appears on the display. Replace the batteries with new fully-charged batteries when this appears. If old batteries are not replaced before they run out, all controls will be disabled.
 - Replace the timer cover.

5. Attach the 4-outlet manifold to an outside hose faucet. Ensure that the 4 outlet controls are in the "off" position.

Note: If desired, the manifold may be secured to the wall below the hose faucet using the mounting hardware and instruction sheet provided.

Note: Retain packaging for storage.

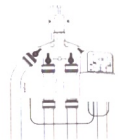

- Fig. 3**
6. Attach up to 4 valves as needed to the 4-outlet manifold (see Fig. 3).

Note: Timer may be mounted in one of two ways:

- On a valve's mounting bracket opposite the manifold connection (see Option A on Mounting Instruction Sheet).
 - On the hose faucet wall within reach of the valve's black connector plug (see Option B on Mounting Instruction Sheet).
7. Select one of the options above to mount the timer. If the wall-mount method is selected, secure the mounting bracket to the wall using the appropriate anchor and screws provided.
 8. Attach up to 4 water connections (as needed) to either the manifold outlets or the valve outlets.
 9. Insert as many black valve connector plugs (as needed) into the open ports underneath the timer.
- Note: Watering stations 1-4 match the connector ports underneath the timer from furthest left to furthest right.
10. Open the individual manifold outlet controls as needed to direct water through an attached watering connection or into the line controlled by a valve.
 11. Turn the faucet on slowly to check for leaks. Tighten manifold, valve or water connection fittings if there are any leaks.

PROGRAMMING

SET CLOCK TIME AND DAY OF WEEK

- Push the RESET button to erase the current settings.
- After pressing RESET the timer automatically will start in the SET mode. The word SET will blink to indicate that it is selected.
- Push CONFIRM button to begin the set mode. The word CLOCK will appear to indicate the time/day setting is active.
- Push + or - button to select the current day of the week. The day selected will flash (see Fig. 4).



Fig. 4

- Push CONFIRM button to accept the day setting and advance to set the clock time. The current time with A.M. or P.M. will flash.
- Push + or - button to select the correct current time.
- Push CONFIRM button to accept the time setting and advance to set watering days (see Fig. 5).



Fig. 5

Note: When no button has been pressed for 1 minute, the timer will automatically switch to the AUTO mode and return to all the programmed settings. You may push MODE button to return to Mode Selecting. Push MODE button to select SET. The word SET will blink to indicate that it is selected.

SET WATERING DAYS

To choose the days of the week for watering: (Note: you can set water time for every day, only certain days, or every 2nd or 3rd day.)

- Push CONFIRM button to begin the set mode.
- Push CONFIRM button two more times to move past the time/day setting. The days of the week will be flashing (see Fig. 6).



Fig. 6

- Push + or - button to advance to the next day, or to the 2nd and 3rd day settings.
- When chosen day(s) are flashing, push the key to toggle the water drop on/off. The water drop indicates the day(s) chosen for watering.
- When the watering days are chosen, push NEXT button to advance to set watering duration (see Fig. 7).

Note: If you choose to only water at intervals of every 2nd or 3rd day, you cannot set specific days of the week for watering. When no button has been pressed for 1 minute, the timer will automatically switch to the AUTO mode and return to all the programmed settings. You may push MODE button to return to Mode Selecting. Push MODE button to select SET. The word SET will blink to indicate that it is selected.



Fig. 7

SET DURATION AND START TIME FOR WATERING

To set the duration (the number of minutes to water in each of four stations) and to set the start times for watering for each of three watering cycles:

- Push CONFIRM button to begin the set mode.
- Push CONFIRM button two more times and NEXT button once to move past the time/day setting and the watering days. STATION (STN) 1 will show to indicate which station is being set. MINS TO RUN will show with two digits or "-" flashing (see Fig. 8).

Note: STNs 1-4 match the connector ports underneath the timer from furthest left to furthest right.

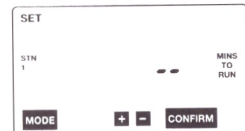

Fig. 8

- Push + or - button to set the duration desired for watering STATION (STN) 1, from 1 to 99 minutes.
- Push CONFIRM button to confirm the duration and advance to set the duration for STATION 2.
- Push + or - button to set the duration desired for watering STATION (STN) 2, from 1 to 99 minutes.
- Push CONFIRM button to confirm the duration and advance to set the duration for STATION 3.
- Push + or - button to set the duration desired for watering STATION (STN) 3, from 1 to 99 minutes.
- Push CONFIRM button to confirm the duration and advance to set the duration for STATION 4.
- Push + or - button to set the duration desired for watering STATION 4 (STN), from 1 to 99 minutes.
- Push CONFIRM button to confirm the duration and advance to set start time.
- There are three unique watering start times, or cycles, that can be set: CYCLE A, CYCLE B and CYCLE C. Each cycle will appear on the screen to specify which one is to be set. One, two or three cycles may be selected (see Fig. 9).



Fig. 9

- Push + or - key to set the start time for CYCLE A.
- Push CONFIRM button to accept this time and advance to set CYCLE B.
- Push + or - button to set the start time for CYCLE B.
- Push CONFIRM button to accept this time and advance to set CYCLE C.
- Push + or - button to set the start time for CYCLE C.
- Push CONFIRM button to accept this time and return to Mode Selecting.

Note: When no button has been pressed for 1 minute, the timer will automatically switch to the AUTO mode and return to all the programmed settings. You may push MODE button to return to Mode Selecting. Push MODE button to select SET. The word SET will blink to indicate that it is selected.

AUTOMATIC WATERING

Once watering days, duration and start times are programmed, the timer will begin automatically.

- Push MODE button to select AUTO. The word AUTO will blink to indicate that it is selected.
- Push CONFIRM button to begin the auto mode. The timer is now ready to begin watering automatically (see Fig. 10).
- When watering begins, MINS TO RUN will alternate with the current time and day to indicate the time left on current cycle.
- In this mode, the unit executes any programmed schedule or default schedule.



Fig. 10

- In this mode, extra (Manual) watering is ceased.
- In this mode, Delay mode is canceled.

Note: When no button has been pressed for 1 minute, the timer will automatically switch to the AUTO mode and return to all the programmed settings. You may push MODE button to return to Mode Selecting. Push MODE button to select SET. The word SET will blink to indicate that it is selected.

MANUAL (EXTRA) WATERING

To add an extra 1 to 99 minutes of watering time for one or all stations: (Note: the manual setting does not alter the automatic settings during or after manual use.)

- Push MODE button to select MANUAL. The word MANUAL will blink to indicate that it is selected.
- Push CONFIRM button to begin the manual mode. STATION (STN) 1 will flash.

- To have all stations water in manual (extra) mode, push CONFIRM button and all the stations will water at the duration previously set.
- To have only one station water in manual (extra) mode, push + or - to select which station to water.
- Push CONFIRM button to confirm the selected station to water. MINS TO RUN will show with two digits or "--" flashing (see Fig. 11).

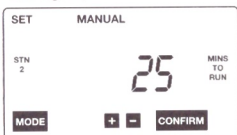

Fig. 11

- Push + or - button to set the duration for the extra watering.
- Push CONFIRM button to confirm the desired duration. The extra watering will begin immediately for the duration selected at the selected station.
- As watering begins, MINS TO RUN will alternate with the current time and day to indicate the time left on manual cycle. The station currently being watered will also show.
- To discontinue the manual watering mode, push + and - together, and extra watering will end immediately.
- When the extra watering is finished, the unit will resume auto mode.

DELAY WATERING

To delay automatic watering for 1-24 hours:

- Push MODE button to select DELAY. The word DELAY will blink to indicate that it is selected. The unit will initiate a 24 hour delay.
- Push CONFIRM button to begin delay mode. "24 Hr" will blink and the word DELAY will appear (see Fig. 12).



Fig. 12

- Push + or - button to change the hour delay within 10 seconds after pushing CONFIRM button to begin delay mode. Otherwise, "24 Hr" and the current day and time will alternate blink and the timer will not accept a delay hour change. If this occurs, repeat the previous three instructions.
- Push CONFIRM button to confirm the delay mode for the desired time.
- LEFT will appear to indicate the time remaining on delay.
- To discontinue delay watering, push MODE button.

OFF MODE

In Off Mode all watering programs are inactive and no watering will occur.

- Push MODE button to select OFF. The word OFF will blink to indicate that it is selected (see Fig. 13).



Fig. 13

- Push CONFIRM button to begin off mode.
- While in off mode, the unit will continue to display current time and day.
- To discontinue off mode, push + and - buttons together. The unit will resume auto mode.

STORAGE & MAINTENANCE

- Disconnect the manifold from the faucet prior to freezing weather to avoid faucet damage.

- Turn the water off at the hose faucet and leave manifold outlet control levers in the "on" position for each connected valve.

- Push MODE button to select MANUAL. The words MANUAL and SET will blink to indicate that they are selected.
- Push CONFIRM button to begin the manual mode. STATION (STN) 1 will appear, indicating the current station
- Push + or - button to advance to the valve station matching the connection to the timer.

Note: STNs 1-4 match the connector ports underneath the timer from furthest left to furthest right.

- Push CONFIRM button to control running time. MINS TO RUN will show with two digits or "--" flashing.
- Push + or - button to set the duration for 1 minute.
- Push CONFIRM button to open valve, draining water and relieving pressure. Repeat the previous six steps, if necessary, for other valve connections with the timer.
- Move the individual manifold outlet control levers to the "off" position.
- Remove as many black valve connector plugs as needed from the ports underneath the timer.
- Remove the timer either from the valve or from the wall-mounted bracket.
- Clean and dry the timer, if needed.
- Remove the batteries. Clean the contacts in the battery compartment. If the batteries show any sign of corrosion, discard them.
- Store timer in a warm and dry place (avoid freezing).
- Remove as many water connections as needed from either the manifold outlets or the valve outlets.
- Remove as many valves as needed from the 4-outlet manifold.
- Remove the 4-outlet manifold from the outside hose faucet.
- Place kit components in original packaging for off-season storage.

TROUBLESHOOTING

PROBLEM/POSSIBLE CAUSES

Water does not turn on:

1. Programming is incorrect.
2. Batteries are too weak to operate valve.
3. Pressure is in excess of 80 psi.
4. Hose faucet is turned off.
5. Timer is in the off or delay mode.

Timer display is blank:

1. Batteries are dead.
2. Faulty display.

Timer will not operate manually:

1. Water to faucet is turned off.
2. Manifold outlet valve is turned off.
3. Timer is in the off mode.
4. Station selected may not match the port station number underneath the timer.

CAUTION:

- Use a lead anchor when installing into masonry; use a plastic anchor when installing into stucco.
- Brace must be installed to avoid damage to the hose faucet. Refrain from putting pressure on the manifold by tugging at the hose.
- For outdoor use with cold water only.
- Check local plumbing codes. Codes vary and some may require use of anti-siphon valves to be installed at the ends of the manifold.
- Freezing areas: Disconnect the manifold from the faucet prior to freezing weather to avoid faucet damage.

MOUNTING INSTRUCTIONS

Option A

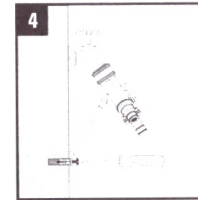
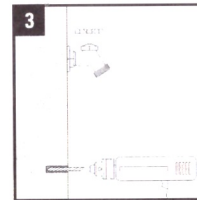
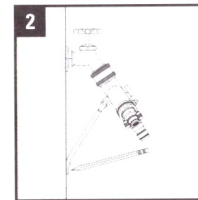
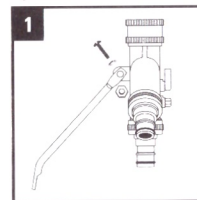

Option B

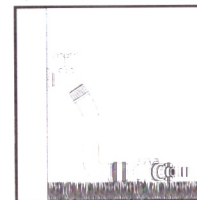

PRODUCT INCLUDES

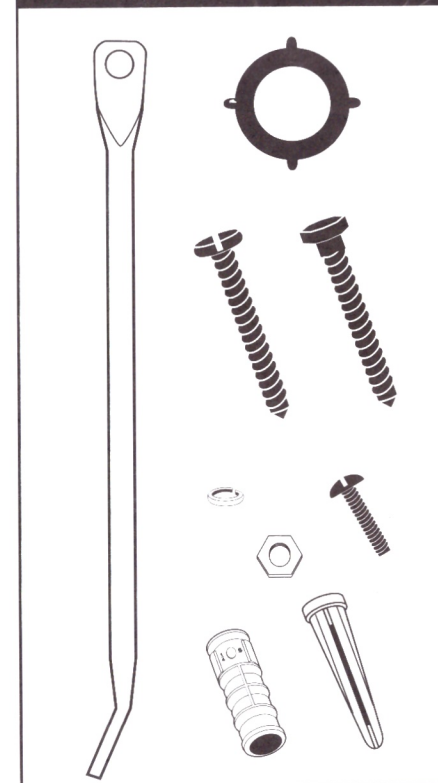

WARRANTY

This YardWorks™ product carries a **two (2) year** warranty against defects in workmanship and materials. Should this YardWorks™ product become defective within the stated warranty period, return it to the store with **proof of purchase**, and it will be replaced or repaired free of charge.

Water Timers

Yardworks Water Timer

How to temporarily TURN ON for 90 Minutes:

Push:	Display Shows:
MODE CONFIRM MODE	Until 'Manual' is blinking, usually 1 push ALL Until ALL, 1 only, or 2 only. ALL runs 90m. on 1, then 90m. on 2 90 MINS TO RUN (and current time) Starts water for your set minutes
+ or - sets minute time CONFIRM	
To turn off when Manual is running water:	
Push: MODE	Display Shows: OFF ...will shut off

NORMAL DISPLAY: When working on Auto Mode, it will read (after 30 seconds of not pushing any buttons) AUTO and the Weekday (e.g. Mo) and the current Time (e.g. 1:22PM) and the word MODE.

TO RESET TIMING of Automatic Mode, you have to go through setting the day of the week and time:

Push:	Display Reads:
MODE	SET / MANUAL Flashing
MODE	OFF
MODE	DELAY
MODE	SET
CONFIRM	MO flashing
CONFIRM	TIME flashing
CONFIRM?	Days, drop shows ON day Etc.



2 TO 4 ZONE WATER TIMER WITH VALVES

Instructions:

TO RESET DAY AND CLOCK

Using a pen press recessed RESET button
Press CONFIRM
Press + / - and CONFIRM to select day
Press + / - and CONFIRM to select time

To reset:

AUTO WATERING

Press MODE to select SET
Press CONFIRM three times
Press + / - and CONFIRM to select watering days
Press NEXT
Press + / - and CONFIRM to select duration for Station 1 (Repeat for other station)
Press + / - and CONFIRM for Cycle A (Repeat for Cycle B & C)

MANUAL WATERING

Press MODE to select MANUAL
Press CONFIRM